

PERCONTEE



INCORPORATED

January 6, 2022

TO: Maryland Dept. of the Environment,
Land Restoration Program

FR: Joseph D. Horton,
Vice President of Construction &
Development

RE: Use of Recycled Material in Sub-grade &
Off-Site Disposal Summary at Percontee Site 2021

To Whom It May Concern,

Grading activities began in January 2021 and ran through late March 2021 in Area "E" as shown on the Reclamation Grading Plans prepared by Soltesz. Quantities for 2021 are summarized on the attached table "Reclamation Grading Quantities". Area "E" is roughly 40% reclaimed. Approximately 4,170 tons of processed recycled concrete was placed as select fill in areas determined to be undercut and re-filled by the geotechnical engineer, (Hillis-Carnes); see attached geotech reports. No asphalt debris was encountered or separated prior to being processed.

Regards,

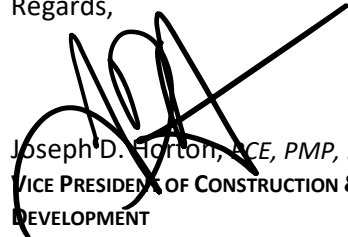

Joseph D. Horton, ACE, PMP, PPE
VICE PRESIDENT OF CONSTRUCTION &
DEVELOPMENT

Reclamation Grading Quantities

Week Ending:	Cut to Fills		Concrete Hauled to Crusher		Trash Excavated & Hauled Off-Site		Undercut & Haul Unsuitable Soil to Stockpile		Recycled Mat'l Placed in Fill	
11/9/2019	100.00	Cyds	119.00	Cyds	-	TN	1,261.00	Cyds	-	TN
11/16/2019	1,326.00	Cyds	-	Cyds	28.65	TN	226.00	Cyds	173.00	TN
11/23/2019	1,224.00	Cyds	102.00	Cyds	-	TN	1,734.00	Cyds	-	TN
11/30/2019	972.00	Cyds	-	Cyds	-	TN	-	Cyds	-	TN
12/7/2019	328.00	Cyds	68.00	Cyds	-	TN	659.00	Cyds	-	TN
12/14/2019	270.00	Cyds	-	Cyds	-	TN	50.00	Cyds	-	TN
12/21/2019					<i>No work completed due to weather and holidays</i>					
12/28/2019					<i>No work completed due to weather and holidays</i>					
1/4/2020					<i>No work completed due to weather</i>					
1/11/2020					<i>No work completed due to weather</i>					
1/18/2020					<i>No work completed due to weather</i>					
1/25/2020					<i>No work completed due to weather</i>					
2/1/2020					<i>No work completed due to weather</i>					
2/8/2020					<i>No work completed due to weather</i>					
2/15/2020					<i>No work completed due to weather</i>					
2/22/2020					<i>No work completed due to weather</i>					
2/29/2020					<i>No work completed due to weather</i>					
3/7/2020					<i>No work completed due to weather</i>					
3/14/2020	1,116.00	Cyds	-	Cyds	-	TN	374.00	Cyds	-	TN
3/21/2020	1,683.00	Cyds	-	Cyds	-	TN	-	Cyds	-	TN
3/28/2020	-	Cyds	-	Cyds	-	TN	-	Cyds	289.00	TN
4/4/2020	544.00	Cyds	-	Cyds	-	TN	-	Cyds	2,618.00	TN
4/11/2020	884.00	Cyds	-	Cyds	-	TN	85.00	Cyds	323.00	TN
4/18/2020					<i>No work completed due to weather</i>					
4/25/2020					<i>No work completed due to weather</i>					
5/2/2020	680.00	Cyds	-	Cyds	-	TN	-	Cyds	-	TN
5/9/2020	1,071.00	Cyds	-	Cyds	-	TN	-	Cyds	-	TN
5/16/2020	5,015.00	Cyds	-	Cyds	-	TN	119.00	Cyds	-	TN
5/23/2020	476.00	Cyds	-	Cyds	-	TN	3,434.00	Cyds	3,451.00	TN
5/30/2020	102.00	Cyds	-	Cyds	-	TN	2,091.00	Cyds	1,173.00	TN
6/6/2020	2,159.00	Cyds	-	Cyds	-	TN	1,598.00	Cyds	1,258.00	TN
6/13/2020	102.00	Cyds	-	Cyds	-	TN	-	Cyds	3,145.00	TN
6/20/2020	3,561.00	Cyds	-	Cyds	-	TN	-	Cyds	-	TN
10/31/2020	782.00	Cyds	680.00	Cyds	570.00	TN	-	Cyds	1,470.00	TN
11/7/2020	-	Cyds	-	Cyds	-	TN	-	Cyds	-	TN
11/14/2020	-	Cyds	-	Cyds	-	TN	-	Cyds	-	TN
11/21/2020	5,202.00	Cyds	34.00	Cyds	20.00	TN	85.00	Cyds	-	TN
11/28/2020	4,114.00	Cyds	-	Cyds	-	TN	-	Cyds	-	TN
12/5/2020	-	Cyds	-	Cyds	-	TN	-	Cyds	-	TN
12/12/2020	969.00	Cyds	-	Cyds	-	TN	-	Cyds	-	TN
12/19/2020	-	Cyds	-	Cyds	-	TN	-	Cyds	-	TN
12/26/2020	-	Cyds	-	Cyds	-	TN	-	Cyds	-	TN
1/9/2021	2,006.00	Cyds	306.00	Cyds	-	TN	-	Cyds	-	TN
1/16/2021	901.00	Cyds	357.00	Cyds	-	TN	-	Cyds	-	TN
1/23/2021	-	Cyds	-	Cyds	-	TN	-	Cyds	-	TN
1/30/2021	-	Cyds	-	Cyds	-	TN	1,853.00	Cyds	4,170.00	TN
2/6/2021	-	Cyds	-	Cyds	-	TN	3,434.00	Cyds	-	TN
2/13/2021	-	Cyds	-	Cyds	-	TN	2,533.00	Cyds	-	TN
2/20/2021	-	Cyds	-	Cyds	-	TN	-	Cyds	-	TN
2/27/2021	-	Cyds	-	Cyds	-	TN	-	Cyds	-	TN
3/6/2021	3,162.00	Cyds	-	Cyds	-	TN	-	Cyds	-	TN
3/13/2021	9,707.00	Cyds	-	Cyds	-	TN	-	Cyds	-	TN
3/20/2021	3,162.00	Cyds	-	Cyds	-	TN	-	Cyds	-	TN
3/27/2021	3,485.00	Cyds	-	Cyds	-	TN	-	Cyds	-	TN
4/3/2021	1,445.00	Cyds	-	Cyds	-	TN	-	Cyds	-	TN
Running Total	56,548.00	Cyds	1,666.00	Cyds	618.65	TN	19,536.00	Cyds	18,070.00	TN
	65%		2%		1%		22%		21%	

Area "F" Completed

Started Working Area "E"

87,604.22 Total Cyds Moved-to-Date

HILLIS-CARNES

ENGINEERING ASSOCIATES

10975 Guilford Road, Suite A
Annapolis Junction, MD 20701
P (410) 880-4788 F (410) 880-4098

LETTER OF TRANSMITTAL

January 20, 2021

Percontee Inc.
11900 Tech Road
Silver Spring, MD 20904

RE: VIVA - White Oak

HCEA Project No.: 16541B

Location: Calverton, MD

We are enclosing:

Materials Engineering Division Reports

Materials Laboratory Reports

CC: Hillis-Carnes Engineering Associates - Chris Hillis

Percontee - Joe Horton

ENCL:

Daily Report #50	1/19/2021
Picture	1/19/2021
Picture	1/19/2021
Picture	1/19/2021
Sketch	1/19/2021

HILLIS-CARNES

ENGINEERING ASSOCIATES

10975 Guilford Road, Suite A
Annapolis Junction, MD 20701
P (410) 880-4788 F (410) 880-4098

FIELD REPORT

Work Order No.: WOHC121001126

Date: January 19, 2021

HCEA Project No.: 16541B **Report No.:** 50

Weather/Temp: Partly Cloudy 37 °F

Project Name: VIVA - White Oak

On Site Time: 5.5 hr

Client: Percontee Inc.

Travel Time: 1 hr

Contractor: Percontee Inc.

Total Time: 6.5 hr

Description of Work:

HCEA representative arrived on site to provide testing and observation services.

HCEA representative observed a two axle Truck load was used to proofroll the subgrade for Area E location. The subgrade at the area proofrolled was found to be stable as no pumping or rutting was observed.

Observed the lifts of off site borrow material, compacted with a smooth drum roller for the Area E (see Sketch). The Nuclear Density Test Method (AASHTO T 99 Method C Standard) was used to determine the percent compaction of the fill placement.

The test results indicated that the compacted material at the areas tested, met the project requirements of 95% of the maximum dry density in general conformance with Standard Proctor Method AASHTO T 99.

Test Performed:

Density Test

Referenced Plan:

Problems:

No

Reviewed By: David Anthony Adkins
1/19/2021 20:38:31

Technician: Nasrat Shah Mozafari







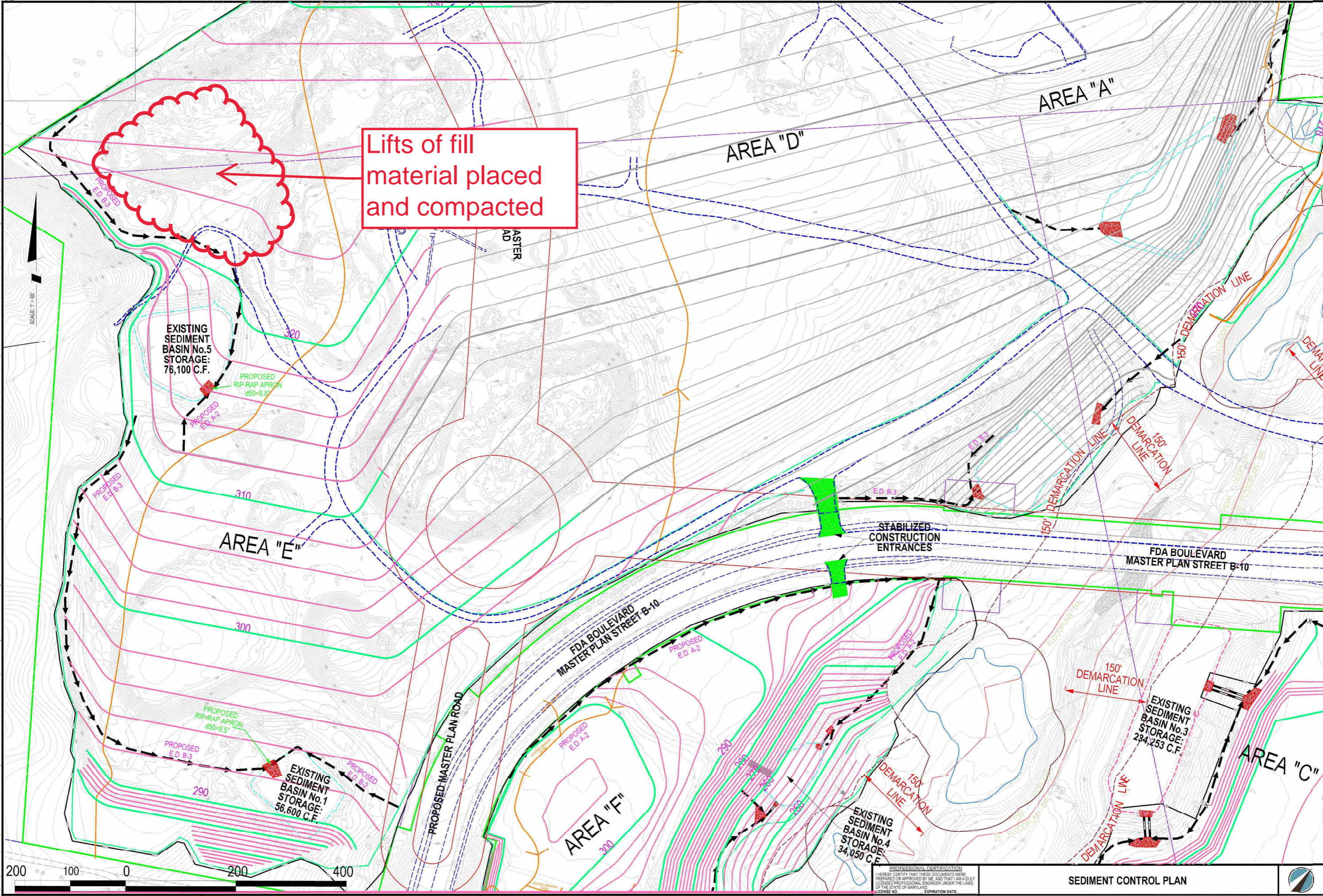

Lifts of fill material placed and compacted

SOLTESZ
 Engineering
 Surveying
 Planning
 Environmental Sciences

Rockville
 Latham
 Waldorf
 Leonardtown
 Frederick
 Soltesz DC, LLC

Rockville Office
 2 Research Place, Suite 100
 Rockville, MD 20850
 P. 301.948.2750 F. 301.948.9067
 www.soltesz.com

NO.	DATE	REVISIONS	BY	DATE

DATE: JULY 2017
 DESIGNED: CWW
 CAD STANDARDS VERSION: 18 - NCS
 TECHNICIAN: CWW
 CHECKED: DEP

MISS UTILITY NOTE
 INFORMATION CONCERNING EXISTING UNDERGROUND UTILITIES WAS OBTAINED FROM AVAILABLE RECORDS. THE CONTRACTOR MUST DETERMINE THE EXACT LOCATION AND ELEVATION OF ALL EXISTING UTILITIES AND UTILITY CROSSINGS BY USING THEIR BEST PRACTICES. WELL IN ADVANCE OF THE START OF EXCAVATION, CONTACT "MISS UTILITY" AT 1-800-251-7777 48 HOURS PRIOR TO THE START OF EXCAVATION. IF CLEARANCES ARE LESS THAN SHOWN ON THIS PLAN OR TWELVE (12) INCHES, WHICHEVER IS LESS, CONTACT THE ENGINEER AND THE UTILITY COMPANY BEFORE PROCEEDING WITH CONSTRUCTION. CLEARANCES LESS THAN NOTED MAY REQUIRE REVISIONS TO THIS PLAN.

OWNER / DEVELOPER / APPLICANT
 GLOBAL LIFESCI DEVELOPMENT CORPORATION
 C/O PERCONTEE, INC.
 11800 TECH ROAD
 SILVER SPRING, MARYLAND 20904
 301-622-0100, 410-935-2599
 CONTACT: JONATHAN M. GENN, ESQ.

MAP NO. 5287	GRID	E2, E3, E4, F2, F3, F4, G2, G3, G4, H2, H3, H4
MAP K0242, G012	GRID	K022, K023, K042
NSIC: 200 SHEET	214NE02	XXXX
215NE02	XXXX	XXXX
216NE02	XXXX	XXXX
217NE02	XXXX	XXXX
218NE02	XXXX	XXXX
219NE02	XXXX	XXXX
220NE02	XXXX	XXXX
HORIZONTAL: NAD 83/01		
VERTICAL: NGVD 29		

PROFESSIONAL CERTIFICATION
 I HEREBY CERTIFY THAT THESE DOCUMENTS WERE PREPARED OR APPROVED BY ME, AND THAT I AM A DULY LICENSED PROFESSIONAL ENGINEER UNDER THE LAWS OF THE STATE OF MARYLAND.
 LICENSE NO. _____ EXPIRATION DATE: _____

SEDIMENT CONTROL PLAN

MINING ABD RECLAMATION PERMIT AREA "E"

PERCONTEE

PARCEL P565, P660, P908, P910, P832, P908, P778, P637, P707, P477

5TH ELECTION DISTRICT, MONTGOMERY COUNTY, MARYLAND

SCALE: 1" = 60'
SHEET 5
OF 11
PROJECT NO. 0027-51-00

The original of this drawing document was prepared by Soltesz, Inc. (SOLTESZ). This document was not obtained directly from SOLTESZ. SOLTESZ cannot guarantee the accuracy of any information that has been transmitted by electronic means. SOLTESZ cannot guarantee that unauthorized changes and/or alterations were not made by others. If verification of the information contained herein is needed, contact should be made directly with SOLTESZ. SOLTESZ makes no warranties, express or implied, concerning the accuracy of any information that has been transmitted by electronic means.

HILLIS-CARNES

ENGINEERING ASSOCIATES

10975 Guilford Road, Suite A
Annapolis Junction, MD 20701
P (410) 880-4788 F (410) 880-4098

LETTER OF TRANSMITTAL

January 20, 2021

Percontee Inc.
11900 Tech Road
Silver Spring, MD 20904

RE: VIVA - White Oak

HCEA Project No.: 16541B

Location: Calverton, MD

We are enclosing:

Materials Engineering Division Reports

Materials Laboratory Reports

CC: Hillis-Carnes Engineering Associates - Chris Hillis

Percontee - Joe Horton

ENCL:

Daily Report #51	1/20/2021
Picture	1/20/2021
Picture	1/20/2021
Picture	1/20/2021
Sketch	1/20/2021

HILLIS-CARNES

ENGINEERING ASSOCIATES

10975 Guilford Road, Suite A
Annapolis Junction, MD 20701
P (410) 880-4788 F (410) 880-4098

FIELD REPORT

Work Order No.: WOHC121001215

Date: January 20, 2021

HCEA Project No.: 16541B **Report No.:** 51

Weather/Temp: Partly Cloudy 41 °F

Project Name: VIVA - White Oak

On Site Time: 8 hr

Client: Percontee Inc.

Travel Time: 1 hr

Contractor: Percontee Inc.

Total Time: 9 hr

Description of Work:

HCEA representative arrived on site to provide testing and observation services.

Observed the lifts of off site borrow material, compacted with a smooth drum roller for the Area E (see Sketch). The Nuclear Density Test Method was used to determine the percent compaction of the fill placement.

The test results indicated that the compacted material at the areas tested, met the project requirements of 95% of the maximum dry density in general conformance with Standard Proctor Method AASHTO T 99.

Test Performed:

Density Test

Referenced Plan:

civil

Problems:

No

Reviewed By: David Anthony Adkins
1/20/2021 18:49:24

Technician: Nasrat Shah Mozafari







Lifts of borrow material placed and compacted

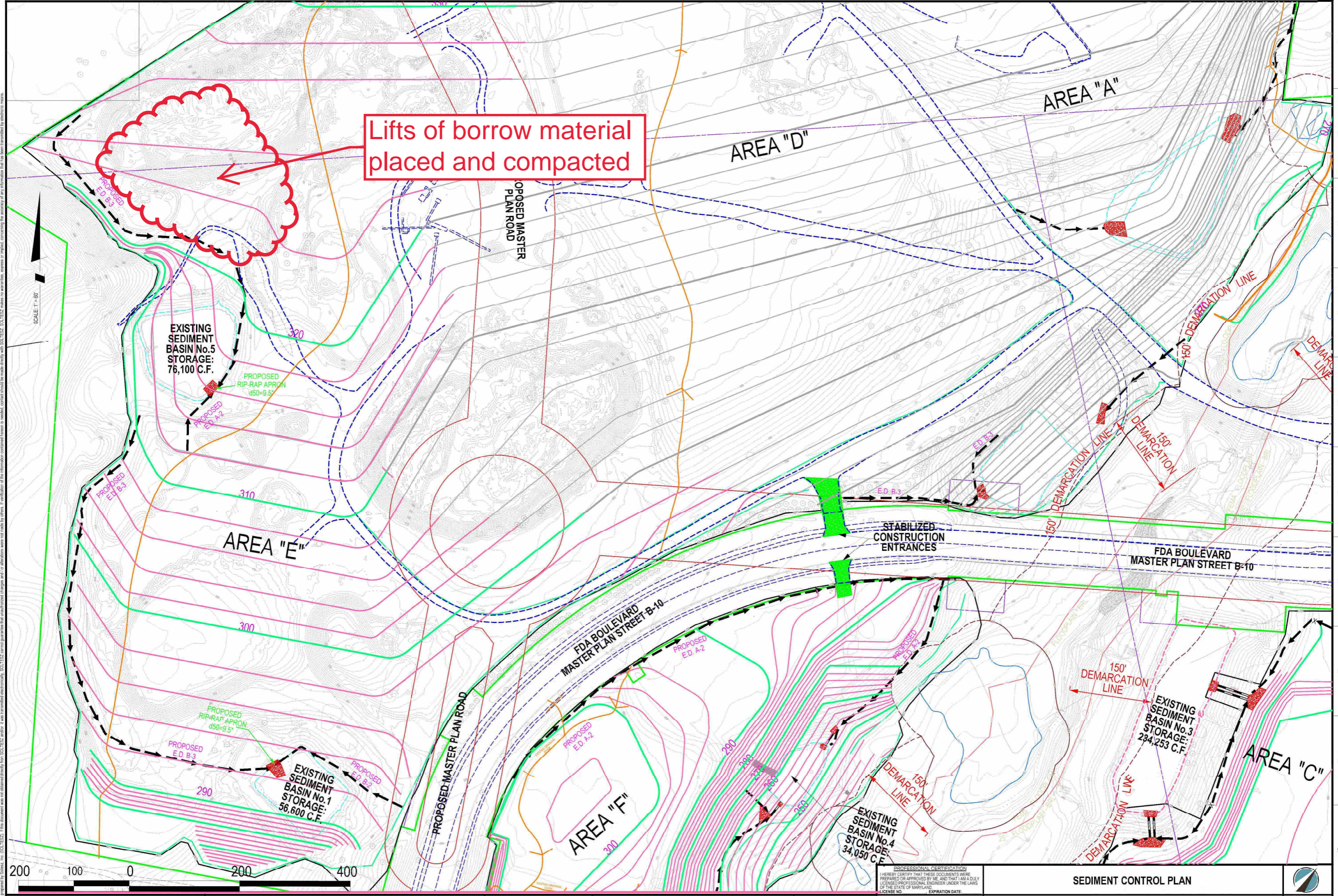

SOLTESZ
 Engineering
 Surveying
 Planning
 Environmental Sciences

Rockville Office
 2 Research Place, Suite 100
 Rockville, MD 20850
 P. 301.948.2750 F. 301.948.9067

Rockville
 Lanham
 Waldorf
 Leesville
 Frederick
 Soltesz OC, LLC

NO.	DATE	DESIGNED	BY	DATE	REVISIONS	VE - NCS
1	JULY 2017	CWW				
2						
3						
4						
5						
6						
7						
8						
9						
10						

MISS UTILITY NOTE
 INFORMATION CONCERNING EXISTING UNDERGROUND UTILITIES WAS OBTAINED FROM AVAILABLE RECORDS. THE CONTRACTOR MUST DETERMINE THE EXACT LOCATION AND ELEVATION OF ALL EXISTING UTILITIES AND UTILITY CROSSINGS BY SOUND TESTS BY HAND WELL IN ADVANCE OF THE START OF EXCAVATION. CONTACT MISS UTILITY AT 1-800-291-7777 48 HOURS PRIOR TO THE START OF EXCAVATION. IF CLEARANCES ARE LESS THAN SHOWN ON THIS PLAN OR THE LINE IS 12 INCHES, WHICHEVER IS LESS, CONTACT THE ENGINEER AND THE UTILITY COMPANY BEFORE PROCEEDING WITH CONSTRUCTION. CLEARANCES LESS THAN NOTED MAY REQUIRE REVISIONS TO THIS PLAN.

OWNER / DEVELOPER / APPLICANT
 GLOBAL LIFESCI DEVELOPMENT CORPORATION
 C/O PERCONTEE, INC.
 11800 TECH ROAD
 SILVER SPRING, MARYLAND 20904
 301-822-0100, 410-835-2599
 CONTACT: JONATHAN M. GENN, ESQ.

MAP NO. 5287	GRID	E2, E3, E4, E2, P3, P4, G2, G3, G4, H2, H1, H4
MAP KODING GRID	ZONING CATEGORY	CR, R, O, C, U, R, O, S, H, Z, O
NSD: 200 SHEET		XXXX
2148E2		
Z15NE2		
Z15NE2		
SITE DATA		
HORIZONTAL: NAD 83/91		XXXX
VERTICAL: NGVD 29		



SEDIMENT CONTROL PLAN

MINING ABD RECLAMATION PERMIT AREA "E"
PERCONTEE
 PARCEL P565, P660, P908, P910, P832, P908, P778, P637, P707, P477

5TH ELECTION DISTRICT, MONTGOMERY COUNTY, MARYLAND

PROJECT NO. 0027-51-00

SHEET 5 OF 11

HILLIS-CARNES

ENGINEERING ASSOCIATES

10975 Guilford Road, Suite A
Annapolis Junction, MD 20701
P (410) 880-4788 F (410) 880-4098

LETTER OF TRANSMITTAL

January 31, 2021

Percontee Inc.
11900 Tech Road
Silver Spring, MD 20904

RE: VIVA - White Oak

HCEA Project No.: 16541B

Location: Calverton, MD

We are enclosing:

Materials Engineering Division Reports

Materials Laboratory Reports

CC: Hillis-Carnes Engineering Associates - Chris Hillis

Percontee - Joe Horton

ENCL:

Daily Report #52	1/29/2021
Picture	1/29/2021
Picture	1/29/2021
Picture	1/29/2021
Picture	1/29/2021
Picture	1/29/2021
Sketch	1/29/2021

HILLIS-CARNES

ENGINEERING ASSOCIATES

10975 Guilford Road, Suite A
Annapolis Junction, MD 20701
P (410) 880-4788 F (410) 880-4098

FIELD REPORT

Work Order No.: WOHC121001911

Date: January 29, 2021

HCEA Project No.: 16541B

Report No.: 52

Weather/Temp: Sunny 28 °F

Project Name: VIVA - White Oak

On Site Time: 5 hr

Client: Percontee Inc.

Travel Time: 1 hr

Contractor: Percontee Inc.

Total Time: 6 hr

Description of Work:

HCEA representative arrived on site to provide testing and observation services.

Observed the lifts of off site borrow material, compacted with a smooth drum roller for the Area E (see Sketch). The Nuclear Density Test Method was used to determine the percent compaction of the fill placement.

The test results indicated that the compacted material at the areas tested, met the project requirements of 95% of the maximum dry density in general conformance with Standard Proctor Method AASHTO T 99.

Test Performed:

Density Test

Referenced Plan:

civil

Problems:

No

Reviewed By: David Anthony Adkins
1/31/2021 13:15:52

Technician: Nasrat Shah Mozafari











approximate area of controlled fill placement and compaction

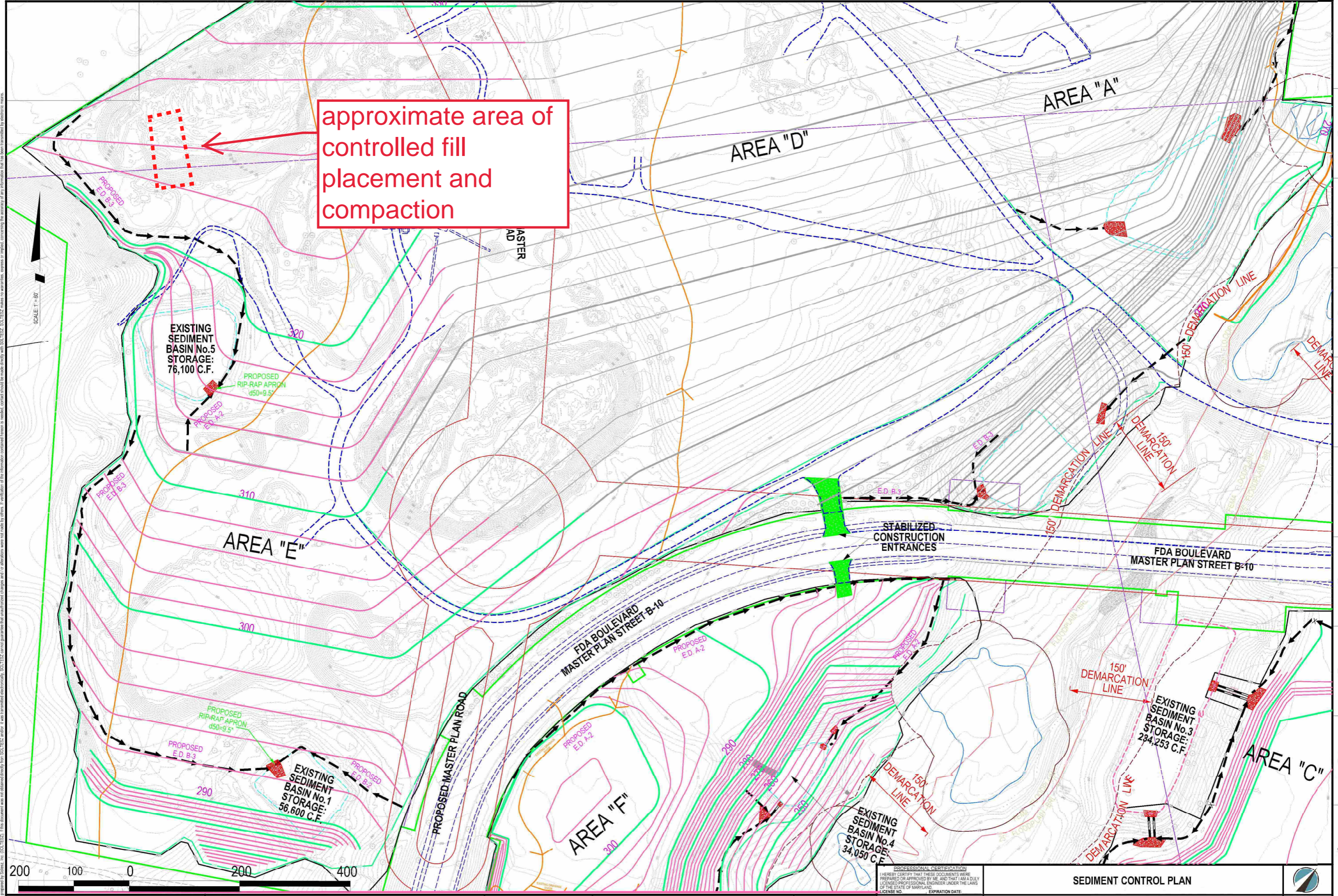

SOLTESZ
 Engineering
 Surveying
 Planning
 Environmental Sciences

Rockville Office
 2 Research Place, Suite 100
 Rockville, MD 20850
 P. 301.948.2750 F. 301.948.9067
 www.soltesz.com

NO.	DATE	DESIGNED	TECHNICIAN	REVISIONS	BY	DATE
1	JULY 2017	CWW	CWW	VE - NCS		

MISS UTILITY NOTE
 INFORMATION CONCERNING EXISTING UNDERGROUND UTILITIES WAS OBTAINED FROM AVAILABLE RECORDS. THE CONTRACTOR MUST DETERMINE THE EXACT LOCATION AND ELEVATION OF ALL EXISTING UTILITIES AND UTILITY CROSSINGS BY CONDUCTING TESTS BY HAND WELL IN ADVANCE OF THE START OF EXCAVATION. CONTACT MISS UTILITY AT 1-800-291-7777 48 HOURS PRIOR TO THE START OF EXCAVATION. IF CLEARANCES ARE LESS THAN SHOWN ON THIS PLAN OR THE LINE IS 12 INCHES, WHATEVER IS LESS, CONTACT THE ENGINEER AND THE UTILITY COMPANY BEFORE PROCEEDING WITH CONSTRUCTION. CLEARANCES LESS THAN NOTED MAY REQUIRE REVISIONS TO THIS PLAN.

OWNER / DEVELOPER / APPLICANT
 GLOBAL LIFESCI DEVELOPMENT CORPORATION
 C/O PERCONTEE, INC.
 11800 TECH ROAD
 SILVER SPRING, MARYLAND 20904
 301-822-0100, 410-835-2599
 CONTACT: JONATHAN M. GENN, ESQ.

MAP NO. 5287	GRID	E2, E3, E4, E2, P3, P4, G2, G3, G4, H2, H1, H4
MAP K0242, GRID K022, K032, K042	ZONING CATEGORY	CR-1.0, C-1.1, R-0.5, H-200
WSID: 200 SHEET 214NE2		XXXX
215NE2		XXXX
216NE2		XXXX
SITE DATA		
HORIZONTAL: NAD 83(91)		
VERTICAL: NGVD 29		

PROFESSIONAL CERTIFICATION
 I HEREBY CERTIFY THAT THESE DOCUMENTS WERE PREPARED OR APPROVED BY ME, AND THAT I AM A DULY LICENSED PROFESSIONAL ENGINEER UNDER THE LAWS OF THE STATE OF MARYLAND.
 LICENSE NO. 17523
 EXPIRATION DATE: 12/31/2021

SEDIMENT CONTROL PLAN

Mining ABD Reclamation Permit Area "E"
PERCONTEE
 PARCEL P565, P660, P908, P910, P832, P908, P778, P637, P707, P477

5TH ELECTION DISTRICT, MONTGOMERY COUNTY, MARYLAND

SHEET 5 OF 11
 PROJECT NO. 0027-51-00